



# Option A: Floor Plans

### ROOM KEY

- |  |                                |                                       |
|--|--------------------------------|---------------------------------------|
| A-01 VESTIBULE / LOBBY                 | D-01 COMMUNITY MEETING ROOMS   | E-01 LAP POOL                         |
| A-02 CASUAL ACTIVITIES LOUNGE          | D-02 COMMUNITY ROOM STORAGE    | E-02 COMMUNITY POOL                   |
| A-03 RECEPTION / CONTROL               | D-03 ARTS & CRAFTS ROOM        | E-03 LAP POOL SURROUNDING SPACE       |
| A-04 CATERING KITCHEN                  | D-04 ARTS & CRAFTS STORAGE     | E-04 COMMUNITY POOL SURROUNDING SPACE |
| A-05 MEN'S LOCKER ROOM                 | D-05 ARTS & CRAFTS POWDER ROOM | E-05 AQUATICS MANAGER                 |
| A-06 WOMEN'S LOCKER ROOM               |                                | E-06 AQUATICS OFFICE                  |
| A-07 FAMILY CHANGE ROOM                |                                | E-07 LIFE GUARD ROOM                  |
| A-08 PUBLIC MEN'S ROOM                 |                                | E-08 POOL MECHANICAL AND HEATER       |
| A-09 PUBLIC WOMEN'S ROOM               |                                | E-09 POOL STORAGE                     |
| A-10 VENDING / REFRESHMENTS            |                                | F-01 NATURE CENTER (OPTIONAL)         |
| A-11 GENERAL STORAGE                   |                                | F-02 SPLASH PARK CONTROL (OPTIONAL)   |
| A-12 MAINTENANCE / RECEIVING / LOADING |                                |                                       |
| A-13 JANITOR'S CLOSET                  |                                |                                       |
| A-14 BUILDING MECHANICAL ROOM          |                                |                                       |
| A-15 ELEVATOR SERVICE ROOM             |                                |                                       |
| B-01 FACILITY DIRECTOR                 |                                |                                       |
| B-02 ASSISTANT FACILITY DIRECTOR       |                                |                                       |
| B-03 PROGRAM MANAGER                   |                                |                                       |
| B-04 PROGRAM COORDINATOR               |                                |                                       |
| B-05 BUILDING MAINTENANCE TECH.        |                                |                                       |
| B-06 STAFF OFFICE                      |                                |                                       |
| B-07 CONFERENCE ROOM                   |                                |                                       |
| B-08 SERVER ROOM                       |                                |                                       |
| B-09 BREAK ROOM                        |                                |                                       |
| B-10 WORKROOM                          |                                |                                       |
| C-01 GYMNASIUM                         |                                |                                       |
| C-02 GYMNASIUM STORAGE                 |                                |                                       |
| C-03 AEROBICS FITNESS AREA             |                                |                                       |
| C-04 ROCK CLIMBING WALL (OPTIONAL)     |                                |                                       |
| C-05 STRENGTH FITNESS AREA             |                                |                                       |
| C-06 AEROBICS DANCE ROOM               |                                |                                       |
| C-07 FITNESS STORAGE                   |                                |                                       |
| C-08 WALKING / JOGGING TRACK           |                                |                                       |



Lower Level Plan: 18,500 S.F.

### COLOR KEY

- LOBBY/CIRCULATION
- BUILDING SUPPORT SPACE
- ADMINISTRATIVE OFFICES
- ACTIVITY SPACES
- COMMUNITY SPACES
- INDOOR AQUATICS
- OUTDOOR AMENITIES



Ground Level Plan: 41,000 S.F.

Total: 59,500 S.F.



## Haverford Township



# Option C: Floor Plans

### ROOM KEY

- |  |                                |                                       |
|--|--------------------------------|---------------------------------------|
| A-01 VESTIBULE / LOBBY                 | D-01 COMMUNITY MEETING ROOMS   | E-01 LAP POOL                         |
| A-02 CASUAL ACTIVITIES LOUNGE          | D-02 COMMUNITY ROOM STORAGE    | E-02 COMMUNITY POOL                   |
| A-03 RECEPTION / CONTROL               | D-03 ARTS & CRAFTS ROOM        | E-03 LAP POOL SURROUNDING SPACE       |
| A-04 CATERING KITCHEN                  | D-04 ARTS & CRAFTS STORAGE     | E-04 COMMUNITY POOL SURROUNDING SPACE |
| A-05 MEN'S LOCKER ROOM                 | D-05 ARTS & CRAFTS POWDER ROOM | E-05 AQUATICS MANAGER                 |
| A-06 WOMEN'S LOCKER ROOM               |                                | E-06 AQUATICS OFFICE                  |
| A-07 FAMILY CHANGE ROOM                |                                | E-07 LIFE GUARD ROOM                  |
| A-08 PUBLIC MEN'S ROOM                 |                                | E-08 POOL MECHANICAL AND HEATER       |
| A-09 PUBLIC WOMEN'S ROOM               |                                | E-09 POOL STORAGE                     |
| A-10 VENDING / REFRESHMENTS            |                                | F-01 NATURE CENTER (OPTIONAL)         |
| A-11 GENERAL STORAGE                   |                                | F-02 SPLASH PARK CONTROL (OPTIONAL)   |
| A-12 MAINTENANCE / RECEIVING / LOADING |                                |                                       |
| A-13 JANITOR'S CLOSET                  |                                |                                       |
| A-14 BUILDING MECHANICAL ROOM          |                                |                                       |
| A-15 ELEVATOR SERVICE ROOM             |                                |                                       |
| B-01 FACILITY DIRECTOR                 |                                |                                       |
| B-02 ASSISTANT FACILITY DIRECTOR       |                                |                                       |
| B-03 PROGRAM MANAGER                   |                                |                                       |
| B-04 PROGRAM COORDINATOR               |                                |                                       |
| B-05 BUILDING MAINTENANCE TECH.        |                                |                                       |
| B-06 STAFF OFFICE                      |                                |                                       |
| B-07 CONFERENCE ROOM                   |                                |                                       |
| B-08 SERVER ROOM                       |                                |                                       |
| B-09 BREAK ROOM                        |                                |                                       |
| B-10 WORKROOM                          |                                |                                       |
| C-01 GYMNASIUM                         |                                |                                       |
| C-02 GYMNASIUM STORAGE                 |                                |                                       |
| C-03 AEROBICS FITNESS AREA             |                                |                                       |
| C-04 ROCK CLIMBING WALL (OPTIONAL)     |                                |                                       |
| C-05 STRENGTH FITNESS AREA             |                                |                                       |
| C-06 AEROBICS DANCE ROOM               |                                |                                       |
| C-07 FITNESS STORAGE                   |                                |                                       |
| C-08 WALKING / JOGGING TRACK           |                                |                                       |



Lower Level Plan: 18,500 S.F.

### COLOR KEY

- LOBBY/CIRCULATION
- BUILDING SUPPORT SPACE
- ADMINISTRATIVE OFFICES
- ACTIVITY SPACES
- COMMUNITY SPACES
- INDOOR AQUATICS
- OUTDOOR AMENITIES



Ground Level Plan: 41,000 S.F.

Total: 59,500 S.F.





# Option A / C : Lobby, Reception, & Gym

Community Recreation/Environmental Facility

June 26, 2007

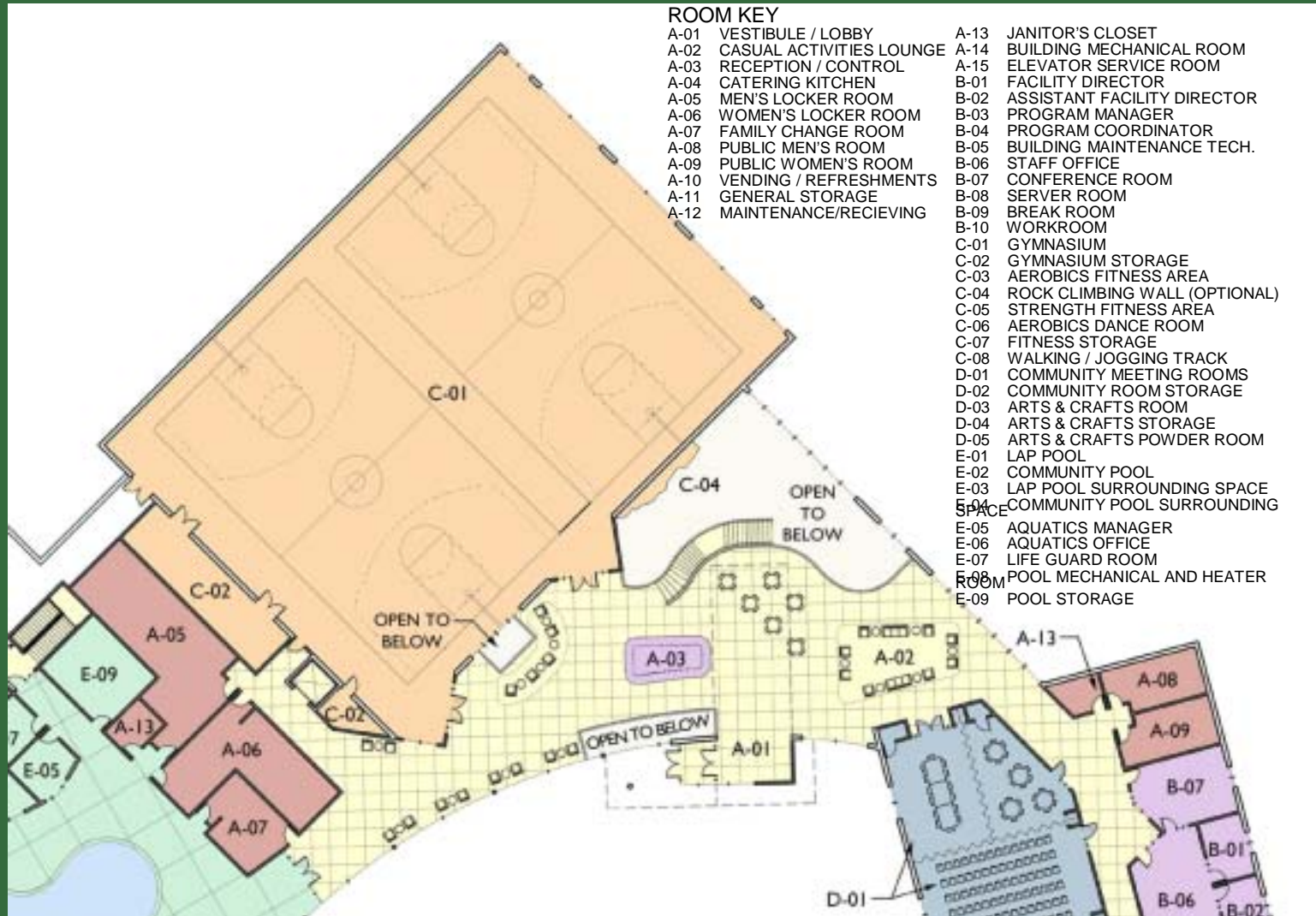

Haverford Township

KIMMEL BOGRETTE  
Architecture + Site



# Option A / C: Community, Admin., & Nature Center

Community Recreation/Environmental Facility

June 26, 2007

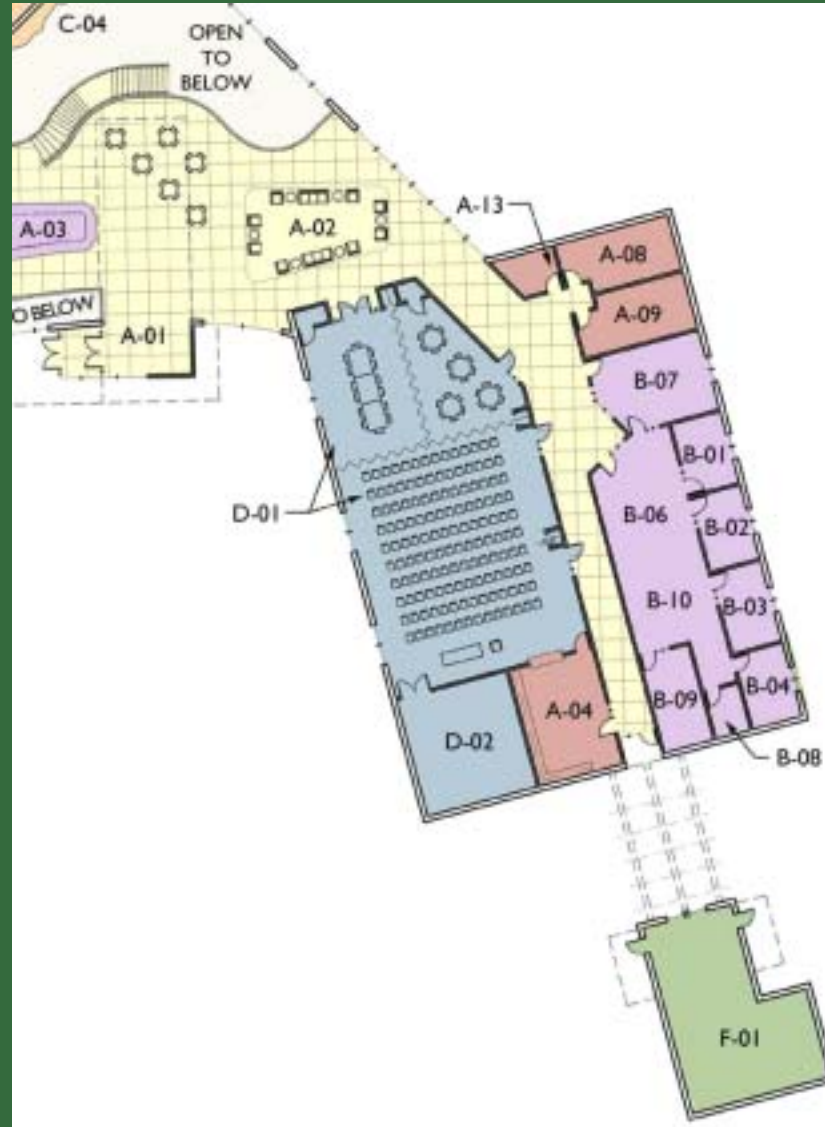

### ROOM KEY

- A-01 VESTIBULE / LOBBY
- A-02 CASUAL ACTIVITIES LOUNGE
- A-03 RECEPTION / CONTROL
- A-04 CATERING KITCHEN
- A-05 MEN'S LOCKER ROOM
- A-06 WOMEN'S LOCKER ROOM
- A-07 FAMILY CHANGE ROOM
- A-08 PUBLIC MEN'S ROOM
- A-09 PUBLIC WOMEN'S ROOM
- A-10 VENDING / REFRESHMENTS
- A-11 GENERAL STORAGE
- A-12 MAINTENANCE / RECEIVING / LOADING
- A-13 JANITOR'S CLOSET
- A-14 BUILDING MECHANICAL ROOM
- A-15 ELEVATOR SERVICE ROOM
- B-01 FACILITY DIRECTOR
- B-02 ASSISTANT FACILITY DIRECTOR
- B-03 PROGRAM MANAGER
- B-04 PROGRAM COORDINATOR
- B-05 BUILDING MAINTENANCE TECH.
- B-06 STAFF OFFICE
- B-07 CONFERENCE ROOM
- B-08 SERVER ROOM
- B-09 BREAK ROOM
- B-10 WORKROOM
- C-01 GYMNASIUM
- C-02 GYMNASIUM STORAGE
- C-03 AEROBICS FITNESS AREA
- C-04 ROCK CLIMBING WALL (OPTIONAL)
- C-05 STRENGTH FITNESS AREA
- C-06 AEROBICS DANCE ROOM
- C-07 FITNESS STORAGE
- C-08 WALKING / JOGGING TRACK
- D-01 COMMUNITY MEETING ROOMS
- D-02 COMMUNITY ROOM STORAGE
- D-03 ARTS & CRAFTS ROOM
- D-04 ARTS & CRAFTS STORAGE
- D-05 ARTS & CRAFTS POWDER ROOM
- E-01 LAP POOL
- E-02 COMMUNITY POOL
- E-03 LAP POOL SURROUNDING SPACE
- E-04 COMMUNITY POOL SURROUNDING SPACE
- E-05 AQUATICS MANAGER
- E-06 AQUATICS OFFICE
- E-07 LIFE GUARD ROOM
- E-08 POOL MECHANICAL AND HEATER ROOM
- E-09 POOL STORAGE
- F-01 NATURE CENTER (OPTIONAL)
- F-02 SPLASH PARK CONTROL (OPTIONAL)



Haverford Township

KIMMEL BOGRETTE

Architecture + Site



# Option A: Community Pool & Lockers

June 26, 2007

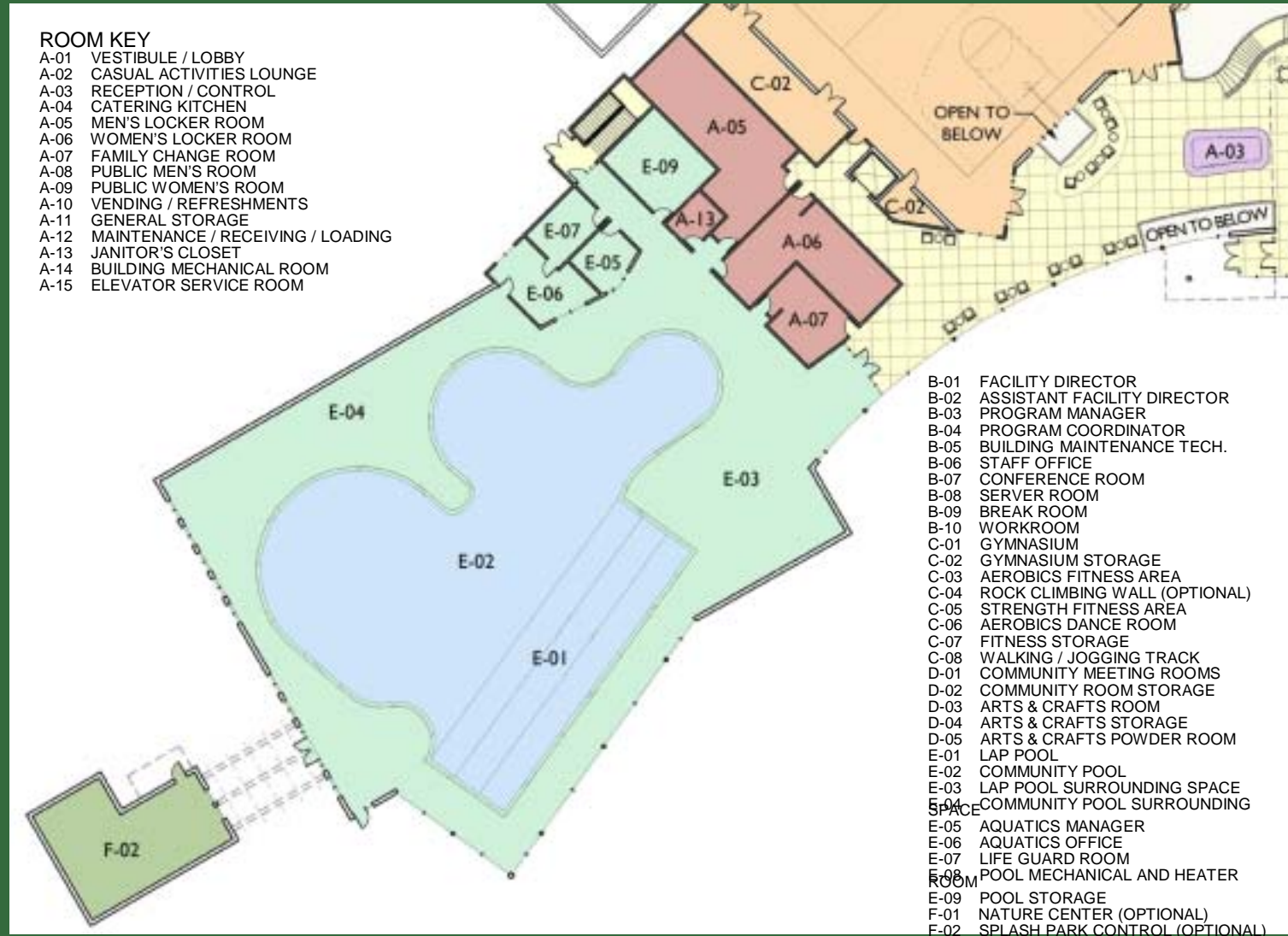

Haverford Township

KIMMEL BOGRETTE  
Architecture + Site



# Community Pool Examples

Community Recreation/Environmental Facility

June 26, 2007



**Haverford Township**

**KIMMEL BOGRETTE**  
Architecture + Site



# Option C: Competition Pool & Lockers

June 26, 2007

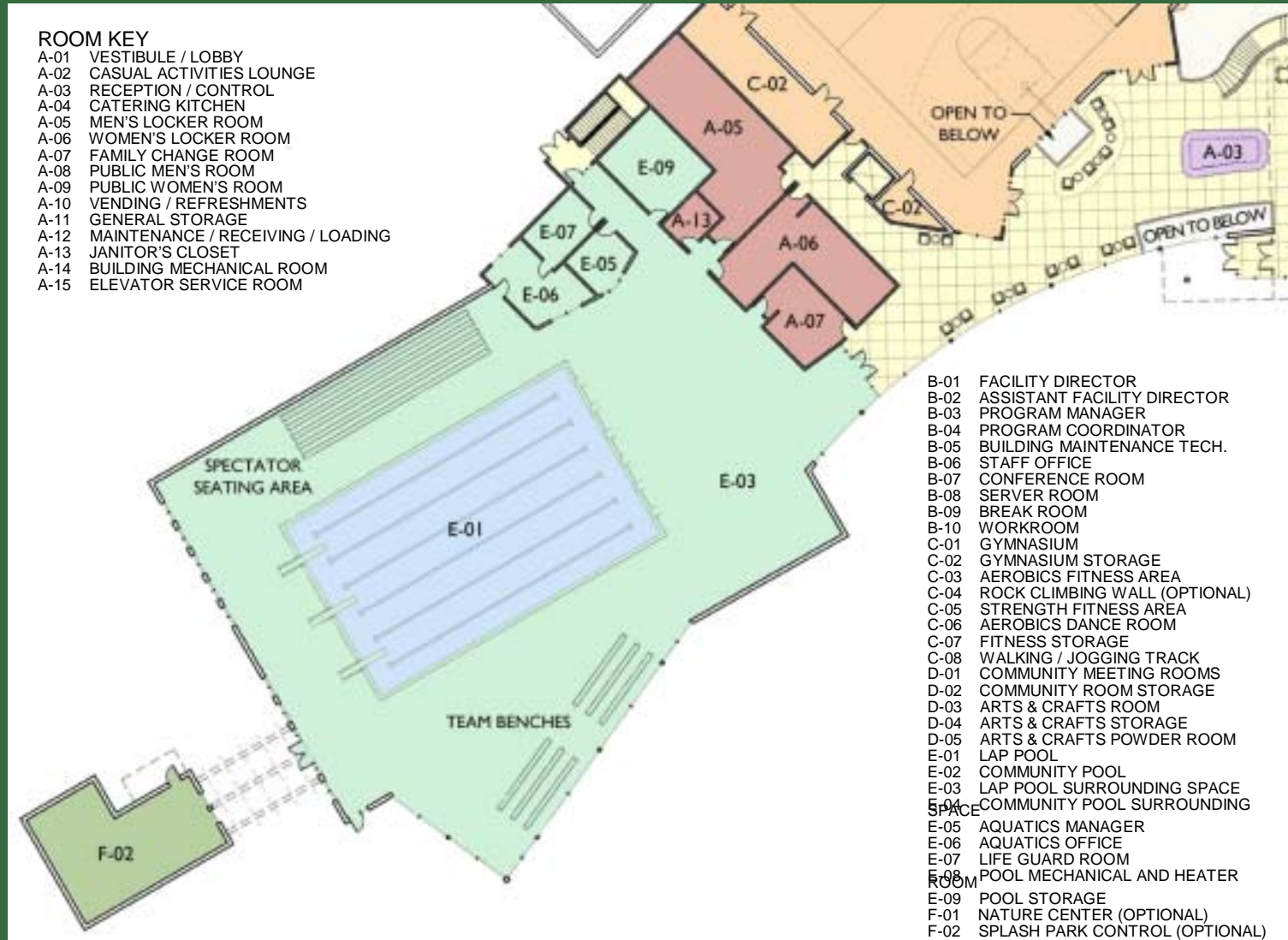

**Haverford Township**



# Competition Pool Examples

Community Recreation/Environmental Facility

June 26, 2007

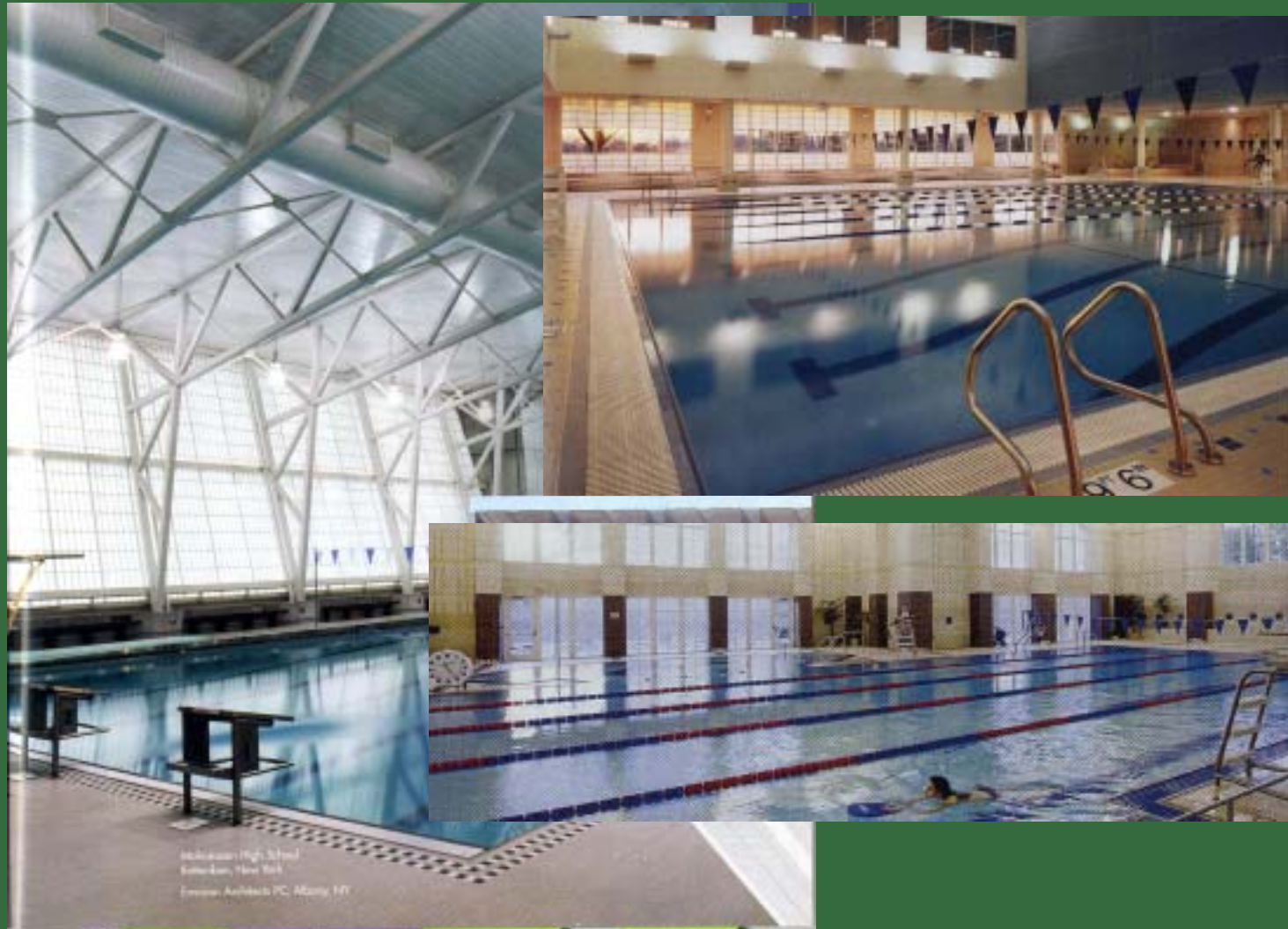

**Haverford Township**

**KIMMEL BOGRETTE**  
Architecture + Site





# Option A / C: Lower Level Plan

### COLOR KEY

- LOBBY/CIRCULATION
- BUILDING SUPPORT SPACE
- ADMINISTRATIVE OFFICES
- ACTIVITY SPACES
- COMMUNITY SPACES
- INDOOR AQUATICS
- OUTDOOR AMENITIES

### ROOM KEY

- A-01 VESTIBULE / LOBBY
- A-02 CASUAL ACTIVITIES LOUNGE
- A-03 RECEPTION / CONTROL
- A-04 CATERING KITCHEN
- A-05 MEN'S LOCKER ROOM
- A-06 WOMEN'S LOCKER ROOM
- A-07 FAMILY CHANGE ROOM
- A-08 PUBLIC MEN'S ROOM
- A-09 PUBLIC WOMEN'S ROOM
- A-10 VENDING / REFRESHMENTS
- A-11 GENERAL STORAGE
- A-12 MAINTENANCE / RECEIVING / LOADING
- A-13 JANITOR'S CLOSET
- A-14 BUILDING MECHANICAL ROOM
- A-15 ELEVATOR SERVICE ROOM
- B-01 FACILITY DIRECTOR
- B-02 ASSISTANT FACILITY DIRECTOR
- B-03 PROGRAM MANAGER
- B-04 PROGRAM COORDINATOR
- B-05 BUILDING MAINTENANCE TECH.
- B-06 STAFF OFFICE
- B-07 CONFERENCE ROOM
- B-08 SERVER ROOM
- B-09 BREAK ROOM
- B-10 WORKROOM
- C-01 GYMNASIUM
- C-02 GYMNASIUM STORAGE
- C-03 AEROBICS FITNESS AREA
- C-04 ROCK CLIMBING WALL (OPTIONAL)
- C-05 STRENGTH FITNESS AREA
- C-06 AEROBICS DANCE ROOM
- C-07 FITNESS STORAGE
- C-08 WALKING / JOGGING TRACK
- D-01 COMMUNITY MEETING ROOMS
- D-02 COMMUNITY ROOM STORAGE
- D-03 ARTS & CRAFTS ROOM
- D-04 ARTS & CRAFTS STORAGE
- D-05 ARTS & CRAFTS POWDER ROOM
- E-01 LAP POOL
- E-02 COMMUNITY POOL
- E-03 LAP POOL SURROUNDING SPACE
- E-04 COMMUNITY POOL SURROUNDING SPACE
- E-05 AQUATICS MANAGER
- E-06 AQUATICS OFFICE
- E-07 LIFE GUARD ROOM
- E-08 POOL MECHANICAL AND HEATER ROOM
- E-09 POOL STORAGE
- F-01 NATURE CENTER (OPTIONAL)
- F-02 SPLASH PARK CONTROL (OPTIONAL)



# Fitness Areas & Jogging Track Examples





# Option B: Floor Plans

### ROOM KEY

- |  |                                |                                       |
|--|--------------------------------|---------------------------------------|
| A-01 VESTIBULE / LOBBY                 | D-01 COMMUNITY MEETING ROOMS   | E-01 LAP POOL                         |
| A-02 CASUAL ACTIVITIES LOUNGE          | D-02 COMMUNITY ROOM STORAGE    | E-02 COMMUNITY POOL                   |
| A-03 RECEPTION / CONTROL               | D-03 ARTS & CRAFTS ROOM        | E-03 LAP POOL SURROUNDING SPACE       |
| A-04 CATERING KITCHEN                  | D-04 ARTS & CRAFTS STORAGE     | E-04 COMMUNITY POOL SURROUNDING SPACE |
| A-05 MEN'S LOCKER ROOM                 | D-05 ARTS & CRAFTS POWDER ROOM | E-05 AQUATICS MANAGER                 |
| A-06 WOMEN'S LOCKER ROOM               |                                | E-06 AQUATICS OFFICE                  |
| A-07 FAMILY CHANGE ROOM                |                                | E-07 LIFE GUARD ROOM                  |
| A-08 PUBLIC MEN'S ROOM                 |                                | E-08 POOL MECHANICAL AND HEATER       |
| A-09 PUBLIC WOMEN'S ROOM               |                                | E-09 POOL STORAGE                     |
| A-10 VENDING / REFRESHMENTS            |                                | F-01 NATURE CENTER (OPTIONAL)         |
| A-11 GENERAL STORAGE                   |                                | F-02 SPLASH PARK CONTROL (OPTIONAL)   |
| A-12 MAINTENANCE / RECEIVING / LOADING |                                |                                       |
| A-13 JANITOR'S CLOSET                  |                                |                                       |
| A-14 BUILDING MECHANICAL ROOM          |                                |                                       |
| A-15 ELEVATOR SERVICE ROOM             |                                |                                       |
| B-01 FACILITY DIRECTOR                 |                                |                                       |
| B-02 ASSISTANT FACILITY DIRECTOR       |                                |                                       |
| B-03 PROGRAM MANAGER                   |                                |                                       |
| B-04 PROGRAM COORDINATOR               |                                |                                       |
| B-05 BUILDING MAINTENANCE TECH.        |                                |                                       |
| B-06 STAFF OFFICE                      |                                |                                       |
| B-07 CONFERENCE ROOM                   |                                |                                       |
| B-08 SERVER ROOM                       |                                |                                       |
| B-09 BREAK ROOM                        |                                |                                       |
| B-10 WORKROOM                          |                                |                                       |
| C-01 GYMNASIUM                         |                                |                                       |
| C-02 GYMNASIUM STORAGE                 |                                |                                       |
| C-03 AEROBICS FITNESS AREA             |                                |                                       |
| C-04 ROCK CLIMBING WALL (OPTIONAL)     |                                |                                       |
| C-05 STRENGTH FITNESS AREA             |                                |                                       |
| C-06 AEROBICS DANCE ROOM               |                                |                                       |
| C-07 FITNESS STORAGE                   |                                |                                       |
| C-08 WALKING / JOGGING TRACK           |                                |                                       |

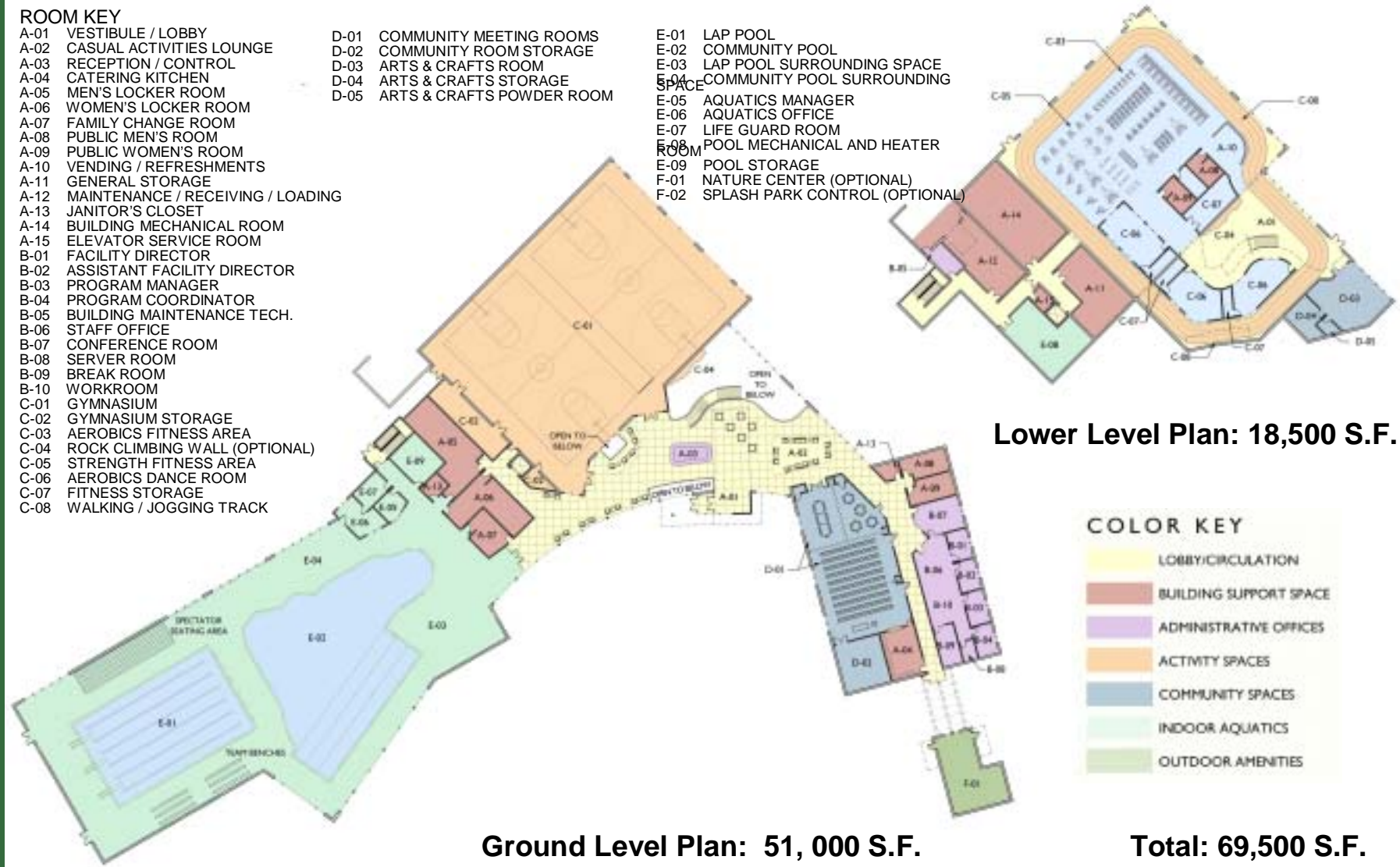

Lower Level Plan: 18,500 S.F.

Ground Level Plan: 51, 000 S.F.

Total: 69,500 S.F.





# Competition & Community Pool Example

Community Recreation/Environmental Facility

June 26, 2007



**Haverford Township**

**KIMMEL BOGRETTE**

Architecture + Site



# Conceptual Image

Community Recreation/Environmental Facility

June 26, 2007



**Haverford Township**

**KIMMEL BOGRETTE**

Architecture + Site